

The Union of transport, forwarder and logistic companies of Siberia

Sergey Maksimov

The state and prospects for the development of the transport and logistics potential of the Novosibirsk region



The zone of influence of the Novosibirsk transport hub

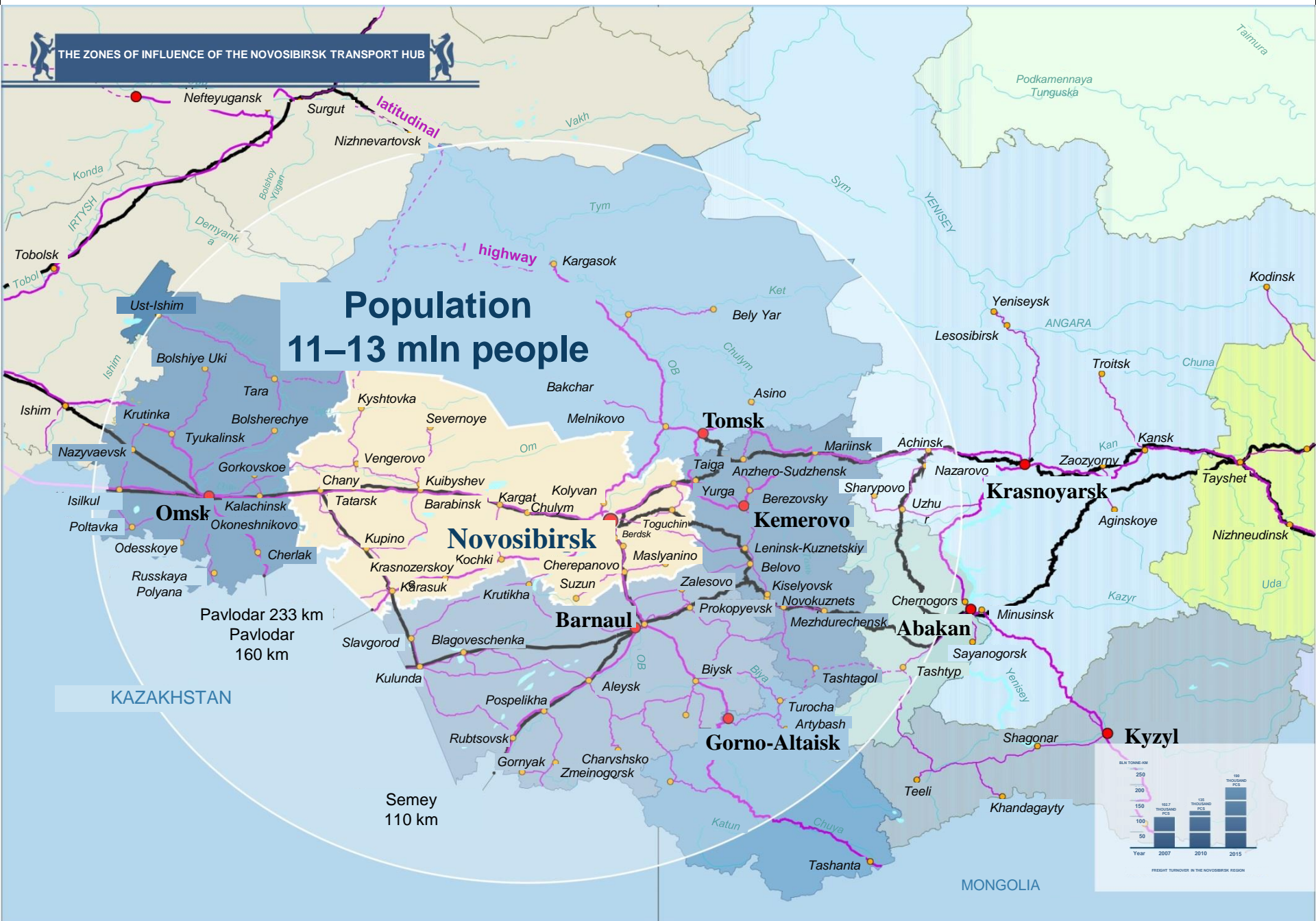

Transport corridors of the Novosibirsk region

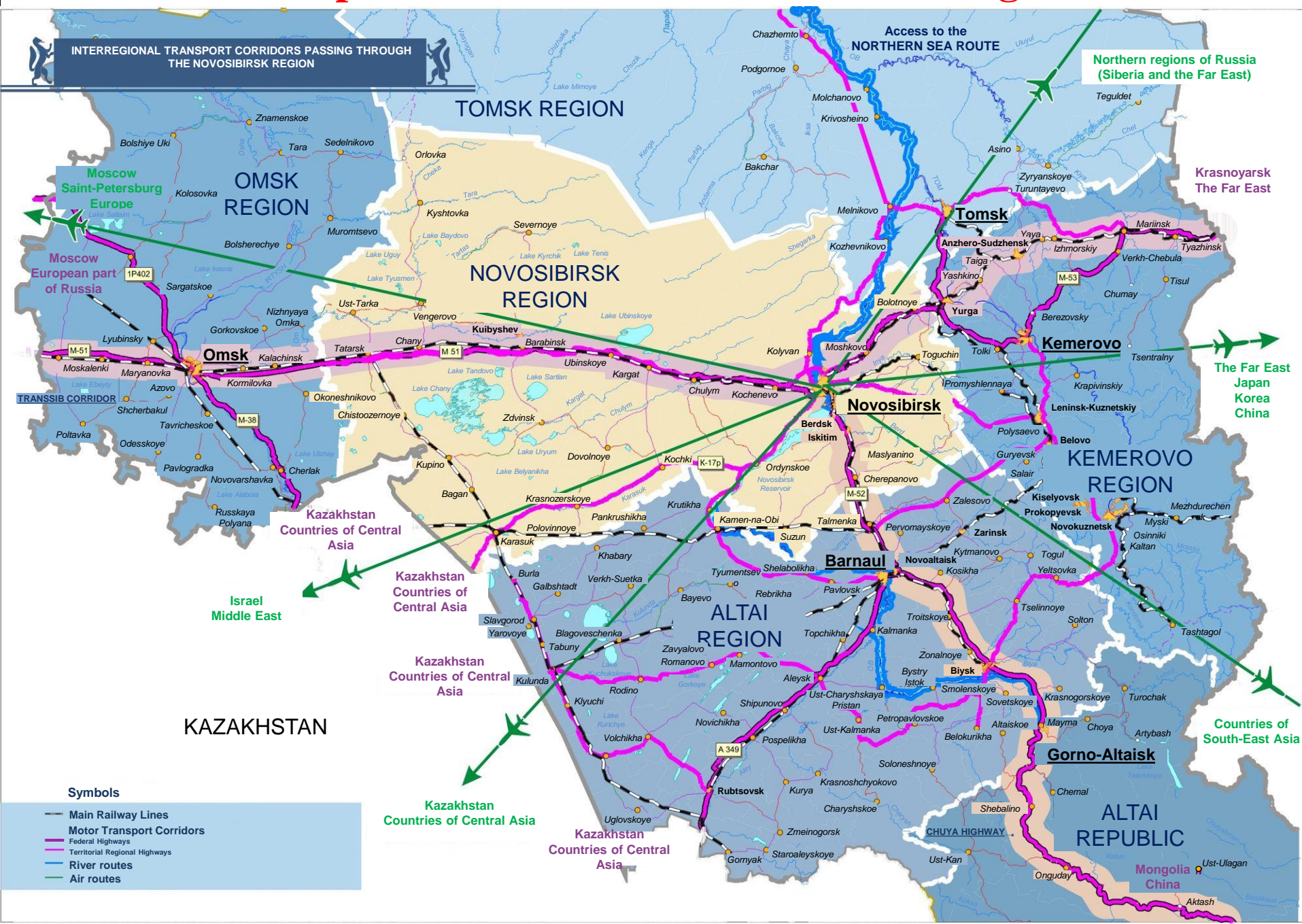

Scheme of transport links of Tolmachevo airport

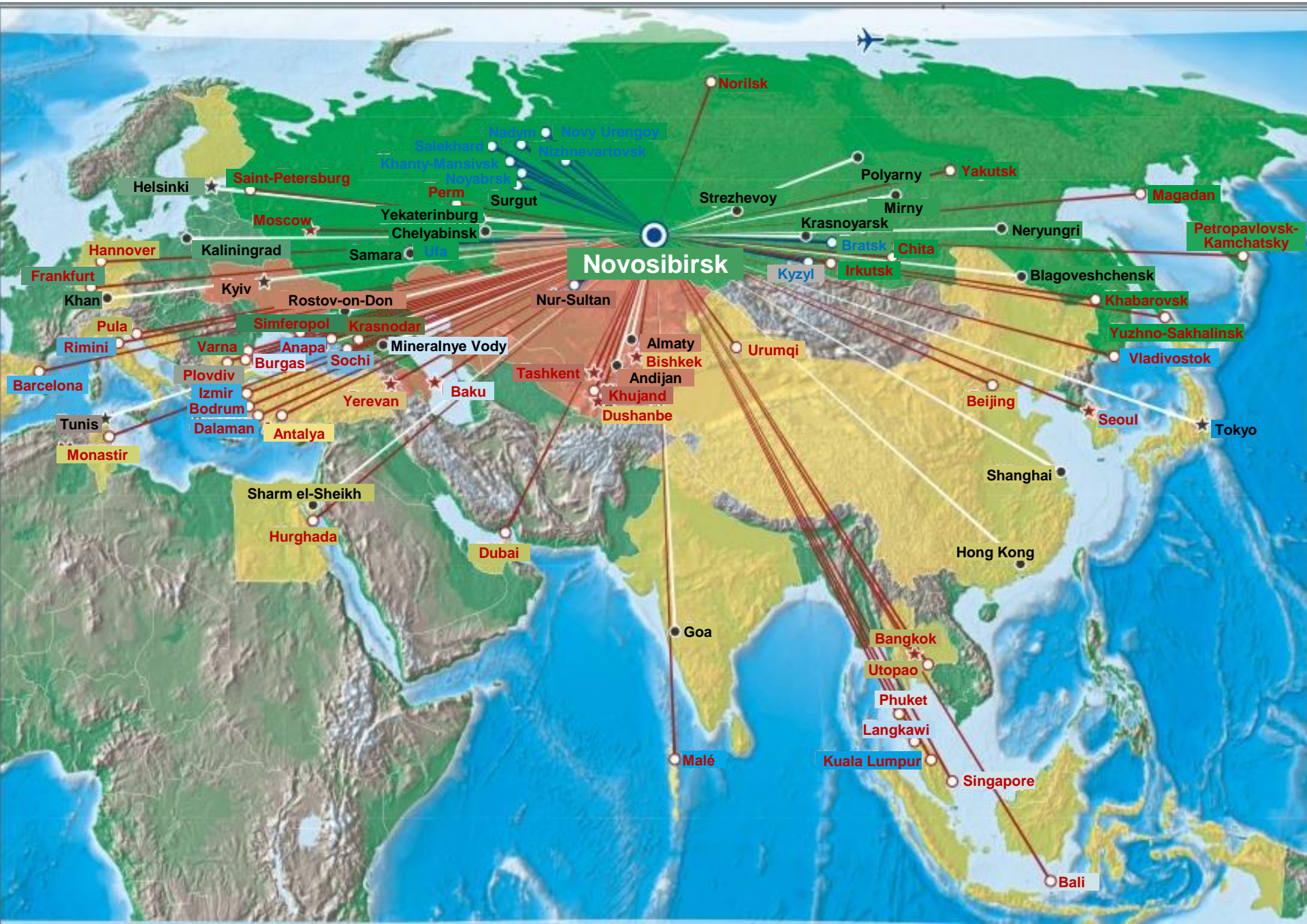

Inskaya Station



**Increase in the volume of processing of large-capacity containers
in the Russian Federation and the Novosibirsk region
(in % compared to the previous year)**

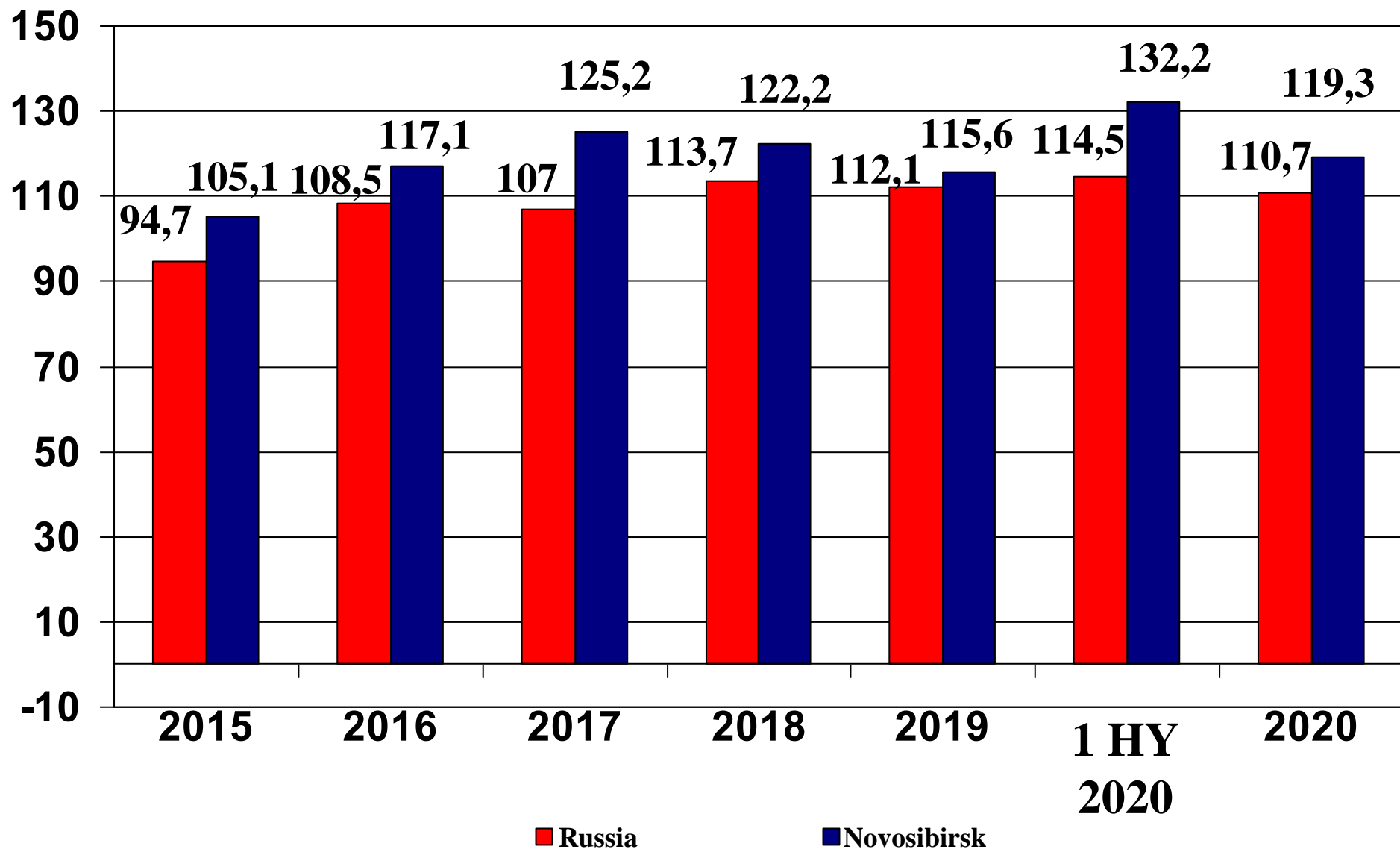

Piggyback transportation – the prospect of development in the VPLP



Prospects for the development of cargo transportation by river transport

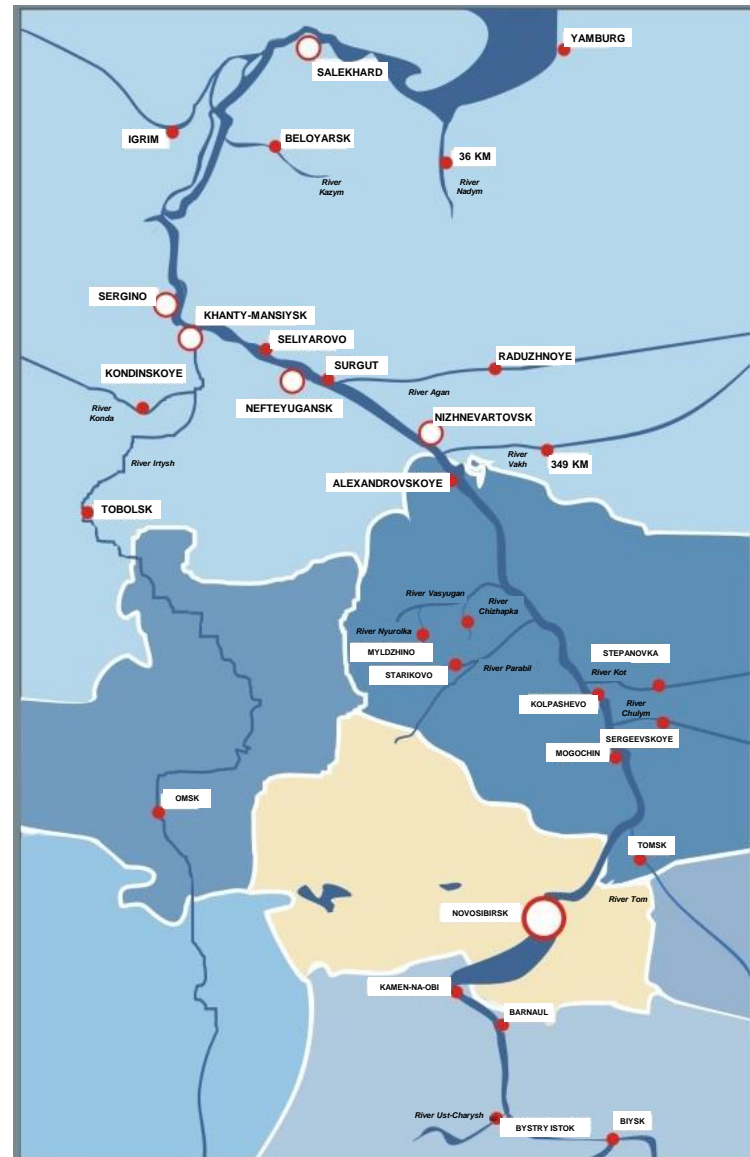

Formation of a raft of container barges for shipping containers to the North of Siberia and the Northern Sea Route – 2005



**The volume of modern warehouses of class A and B
in Western Siberia (as of 01.01.2021, thousand sq. m.)**

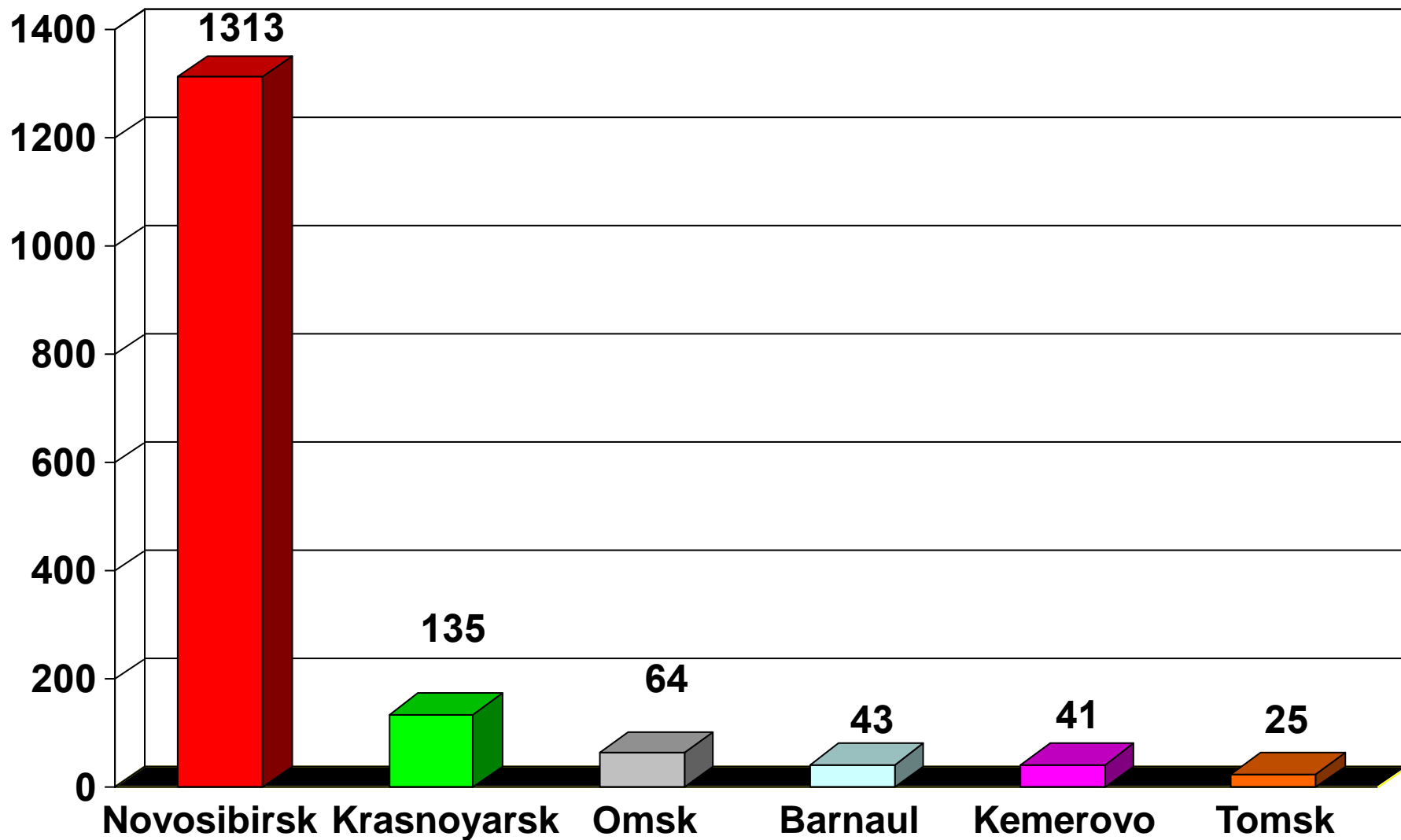

The ratio of storage capacities on the left and right banks of the Novosibirsk agglomeration

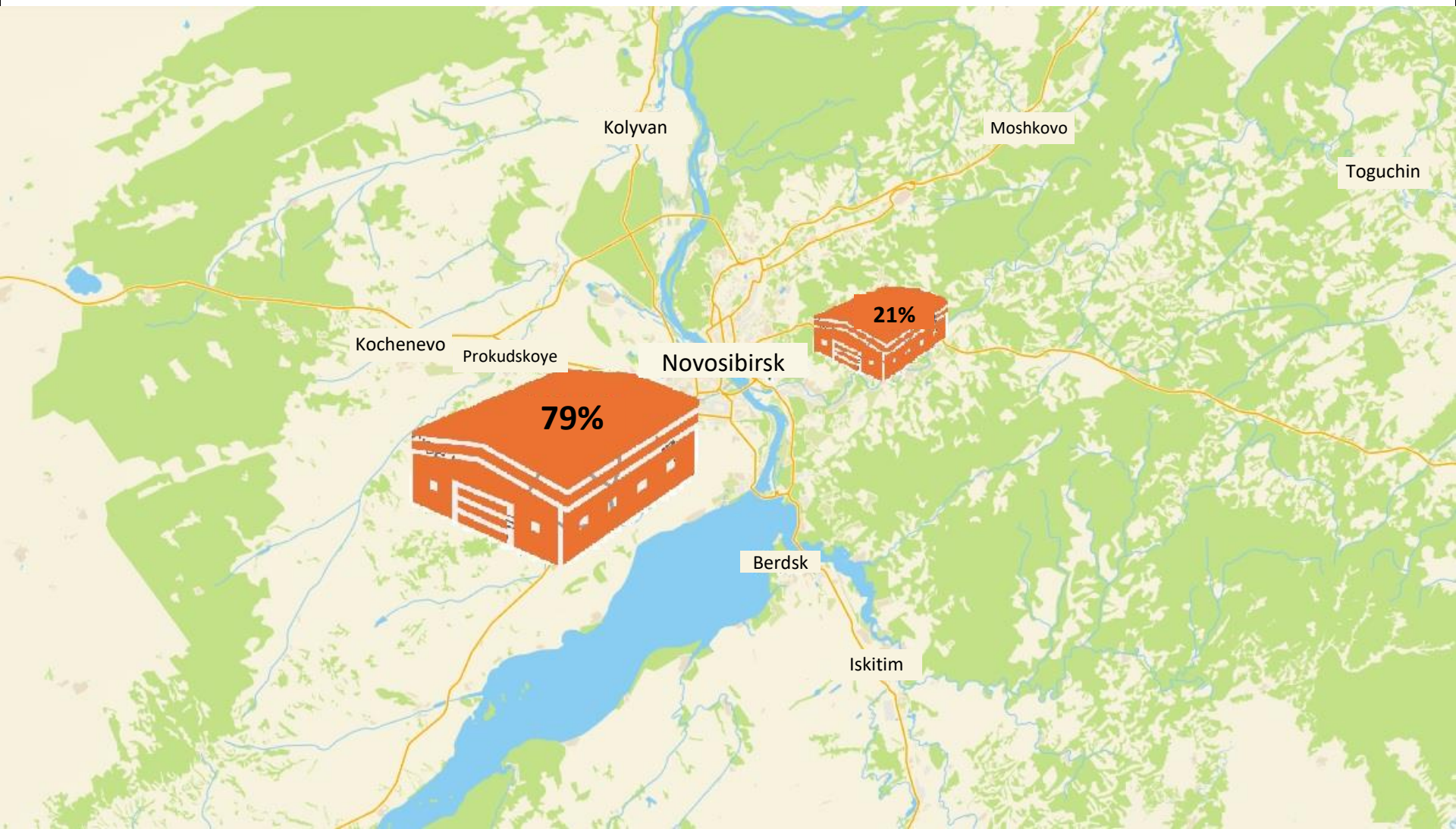

Transport and logistics zones of the Novosibirsk hub

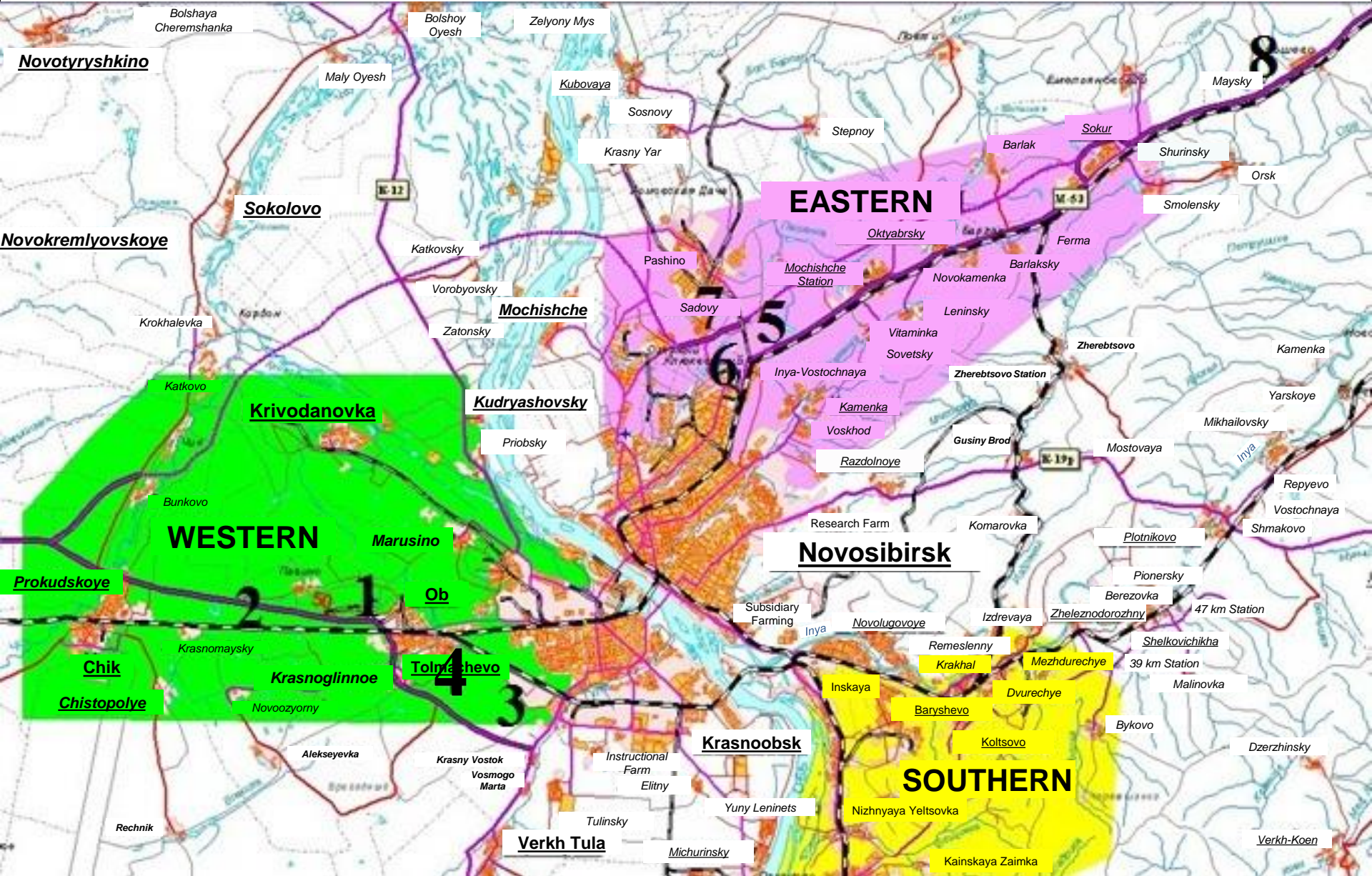

Cargo intermodal terminal of Tolmachevo Airport



Kleshchikha Container terminal



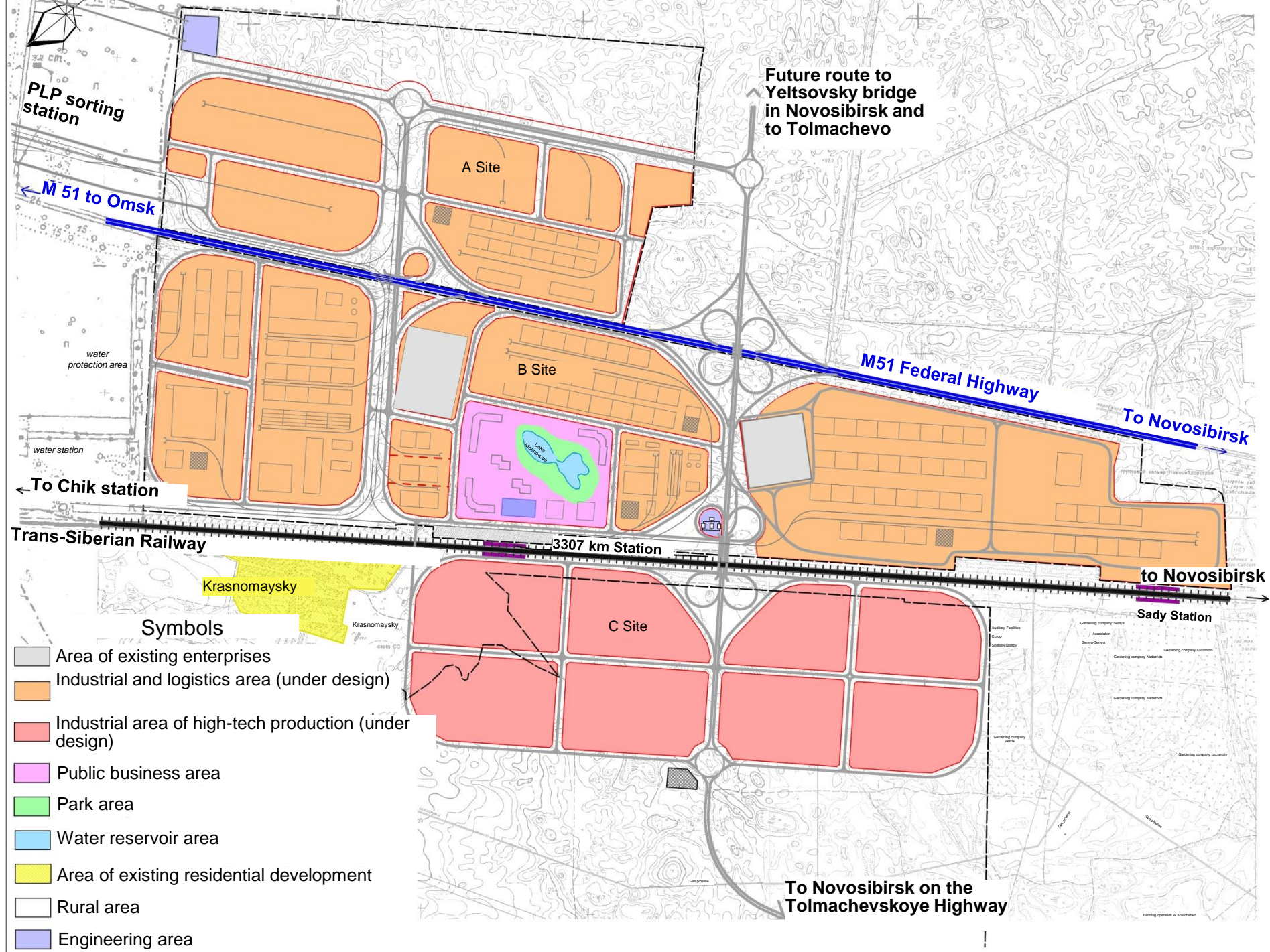

Novosibirsk Transport Terminal on PLP

TECHNICAL CHARACTERISTICS

Capacity:



300 thousand
TEU per year



5 train pairs
per day

Number of loading/unloading areas:

3 areas

Loading/unloading machinery



7 Kalmar reach stackers



Ensuring smooth operation of the terminal, taking
into account climate patterns of the region

Cargo tracking service

Electronic cargo tracking system significantly reduces
the time needed to locate and release cargo to the
customer



The Union of transport, forwarder and logistic companies of Siberia (STELS)



The Union of transport, forwarder and logistic companies of Siberia (STELS)

STELS was founded in May 2011

Currently includes 28 companies

Areas of work of the companies: railway, automobile, aviation, river and sea transportation; forwarding; customs escort of goods; operation of warehouse complexes; express delivery

During the work of STELS, more than 20 joint projects have been implemented

Vostochny Industrial and Logistics Park



"Vostochny Terminal" on the VPLP

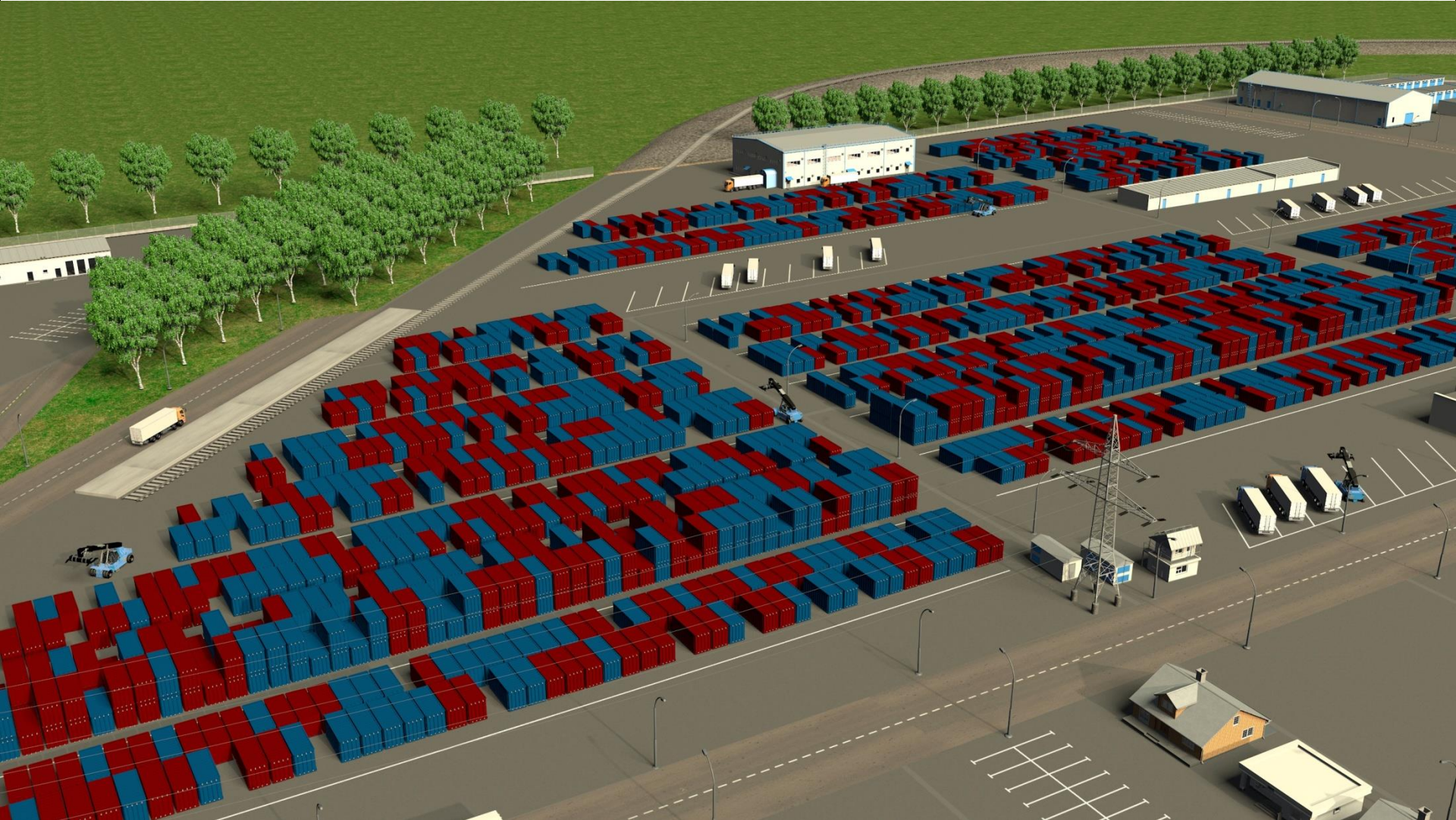

Characteristics of the "Vostochny Terminal" on the VPLP

The first stage:

The terminal area is 4.2 hectares,
the annual turnover is 28 thousand TEU

The second stage:

The terminal area is 6.5 hectares,
the annual turnover is 40.5 thousand TEU

Logistics complex and container terminal of the company "Eurosib"



Development of the Eurosib container terminal

	2020	2022	2026
Length of tracks, m	7,389	9,050	9,050
Site capacity, TEU	4,500	7,000	9,500
Processing capacity, TEU/year	100,000	200,000	250,000
Number of reach stackers, units.	3	9	9
Number of cranes, units.	-	-	4

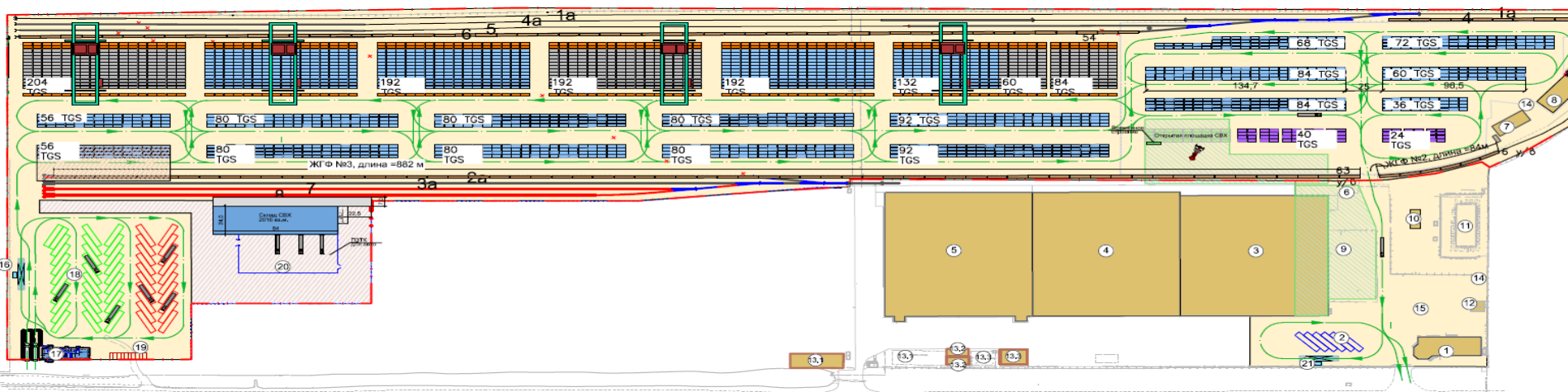

Increase of processing capacity up to 250 thousand tons. TEU per year

Industrial and logistics Park "Moshkovsky"



A full-cycle logistics process is being implemented:

Delivery of raw materials – Wood processing – Loading into containers
- Formation of a container train



Production areas



Warehouses



Garage complexes



Container site



Administrative complexes

Container terminal at the Moshkovsky PLP with the prospect of forming 3 – 4 container trains per month

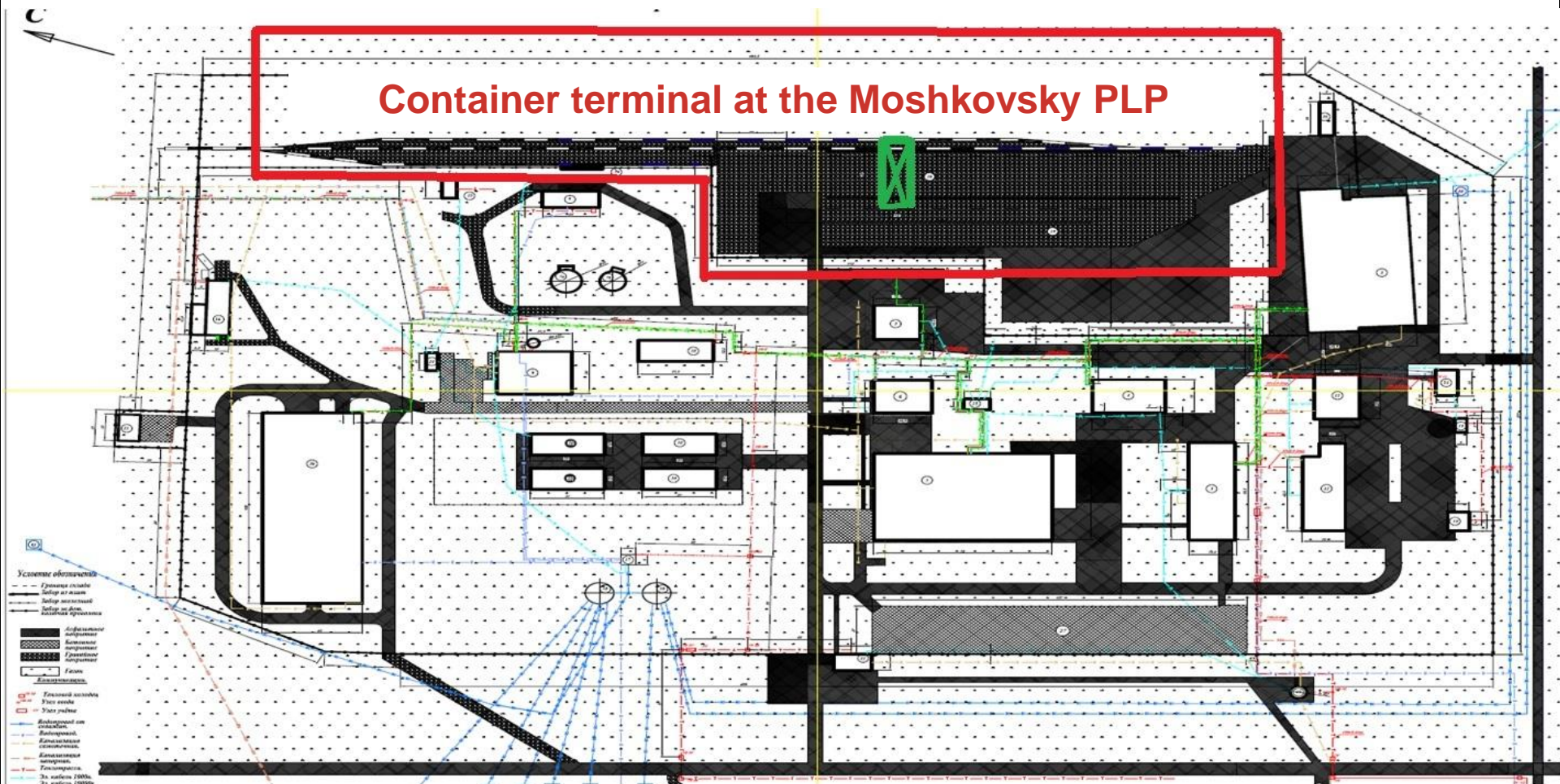

ATT COMPANY IN NUMBERS

over **50 000** containers transported

12 years in the transport services market

over **150** accelerated train routes

over **500** clients

over **1 000 000** tons of cargo shipped



21 years
on the
Russian
market

200 000+
parcels per day

20 000
employees



3 600+
points of issue

800+
postamats

25
countries

1 500 000+
active clients

8 000+
couriers

CDEK in the world

3300+ Russia

50 China

106 Kazakhstan

63 Belarus

18 Kyrgyzstan

7 Uzbekistan

2 Korea

1 Thailand

1 Bulgaria

1 Spain

1 Portugal

2 Vietnam

3 Italy

1 Poland

3 USA

1 UAE

1 Israel

1 Finland

1 Azerbaijan

1 Armenia

1 Abkhazia

2 Georgia

3 Turkey

3 Germany

1 United Kingdom

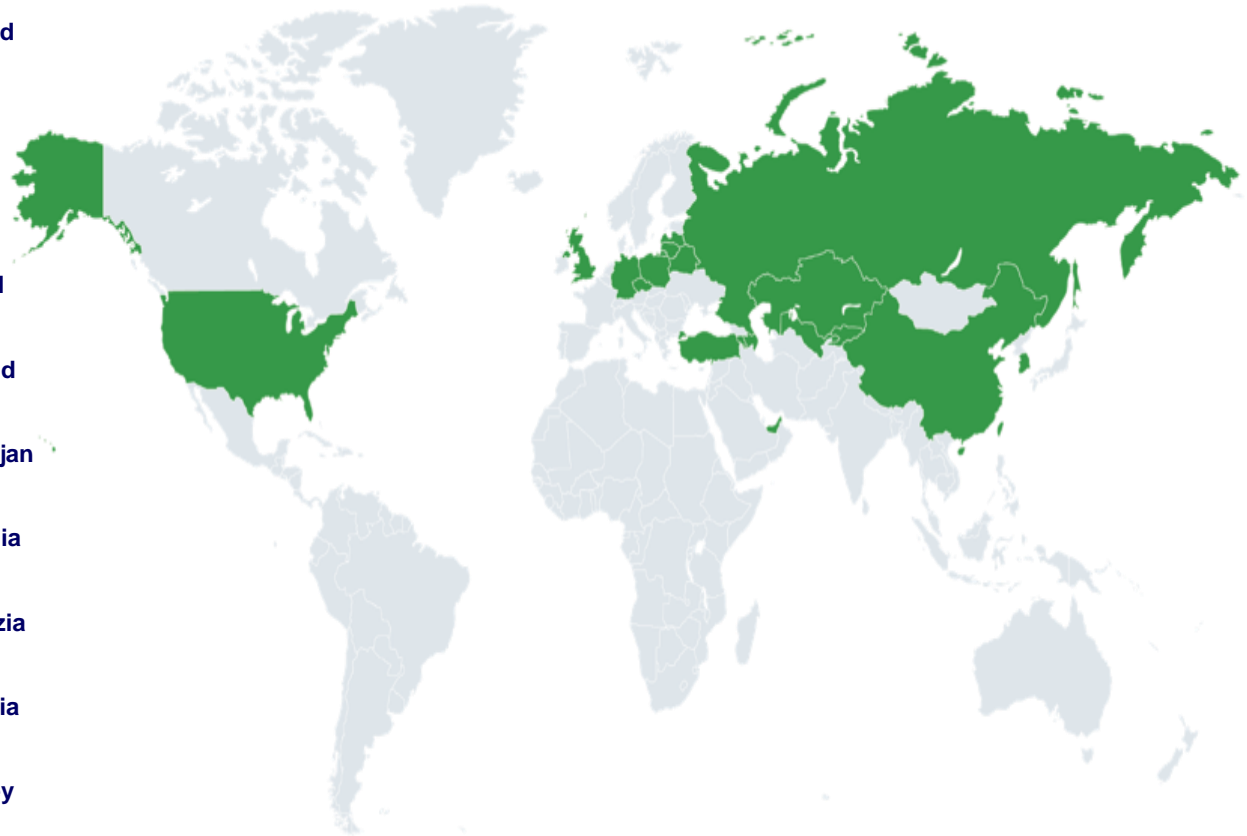

25

countries

**Representative offices of the company in Russia,
Germany, China and Kazakhstan**

SDEK franchise: Product line



PVZ / PFD Office

The opening is
agreed separately,
based on the needs
in the region

1



PVZ + Pedestals

The opening is
agreed separately,
based on the needs
in the region

2



District center

For cities with a
population of
less than 50,000
inhabitants

3

<https://cdekfranchise.kz/>

Postamates OMNICDEK

Postamat - is an automated delivery point for parcels ordered by a customer in an online store, available 24/7.

- Installed near the home or office of potential customers
- Eliminates the problem of the human factor
- It takes less than a minute to receive a parcel
- A convenient and popular format for customers



The District Center Project

For localities with a population of less than 50,000 people



There are no competitors



Simple room requirements



Increased compensation for operations



the deposit is refunded after
6 months

12 months

without royalties

10%

royalties from the 13th
month

Key projects for e-commerce

Fulfillment



Sales
optimization

SDEK.Forward



Mail
forwarding
from 11
countries

Fulfillment of SDEK

10 warehouses in Russia:

Moscow

Saint-Petersburg

Yekaterinburg

Ufa

Tyumen

Krasnodar

Krasnoyarsk

Khabarovsk

Omsk

Rostov-on-Don

1 in Kazakhstan

Nursultan



Fulfillment

Opportunities

Warehouse accounting

Acceptance, shipment,
balances in online mode.
Printing documents and
analytics

Order processing

Setting up integration
or personal account

Shipping to the marketplace

Integrations

Open API and
ready-made
modules

Seasonality

Connection of
warehouses to
choose from or a
combination in the
sale seasons

Economy and speed

Cost reduction

<https://ff.cdek.ru/>



Liberal Values Logistics Terminal



Location of the Logistics Terminal



The Liberal Values logistics terminal is located on the route of import of goods from China and Uzbekistan in transit through the territory of the Republic of Kazakhstan, in the immediate vicinity of the checkpoint MAPP Veseloyarsk on the A349 highway. We offer the best customs and warehouse service in the format of the only modern Logistics Terminal on the border. The geographical location of the Liberal Values Logistics Terminal lies on the route of import of goods from the following border crossings:

Chuguchak (Tacheng) (China) / Bakhty (Republic of Kazakhstan)

Alashankou (China) / Dostyk (Republic of Kazakhstan)

Khorgos (China) / Nur Zholy (Republic of Kazakhstan)

Zimunai (China) / Maykapchagai (Republic of Kazakhstan)

t/p Yallama (Republic of Uzbekistan) / T/P im. Bauyrzhana Konysbayeva (Republic of Kazakhstan)

Liberal Values Logistics Terminal services

- **Expert customs clearance service**

Carrying out customs clearance at the border of the Russian Federation allows Customers to significantly save on international transportation, since cargo delivery under customs control is more expensive. By using the comprehensive customs clearance services of Liberal Values , you can avoid unnecessary questions and difficulties during the declaration by customs.

- **Storage at the SVH and Customs warehouse**

The temporary storage warehouse and Customs warehouse has a sufficient volume of storage space of 2300 sq. m. (with a useful volume of 4500 cubic meters. m), as well as an open area of 3500 sq. m. Class A warehouses are equipped with a fire and security alarm system, as well as a video surveillance system.

- **Marking at the customs warehouse**

We provide services for labeling goods in accordance with the requirements of the Honest Sign system and the Technical Regulations of the EAEU



Liberal Values Logistics Terminal services

- **Representation of interests in the customs authority**

Thanks to the professionalism of the employees and the excellent reputation of Liberal Values , the company has the opportunity to maintain professional and business relations with customs authorities.

- **Implementation of quarantine and veterinary control**

We solve the task of carrying out quarantine and veterinary control at the border in a matter of hours, thanks to extensive work experience and interaction with regulatory authorities. Services on art . Lokot (KTZ)

- **Services on art . Lokot (KTZ)**

The station Lokot (KTZ) is located in the village of Veseloyarsk, in the area of operation of the Gornyskiy t /p, the railway station code is 711001. We are ready to provide a comprehensive service for customs clearance at art. An elbow that will include: the creation of a temporary customs control zone, filing a declaration, filing/cleaning a carriage to a dead end, the service of the consignee/shipper



TETRA TRANS GROUP

BRANCHES IN MAJOR CITIES OF RUSSIA

OPTIMISING THE LOGISTICS
OF OUR CUSTOMERS' SHIPMENTS.

CONTAINERS READILY AVAILABLE

OVER 2,000 COMPANY-
OWNED CONTAINERS
FOR SHIPMENTS TO ANY
DESTINATIONS

OWN FLEET OF CONTAINER TRUCKS

ROUND-THE-CLOCK JUST-IN-TIME
LOADING



+7 800 333 46 42

 TETRA
TRANS

CARGO SHIPPING

IN CONTAINERS ALL OVER RUSSIA

- ▶ CARGO ACCEPTANCE AND SHIPMENT IN CONTAINERS BY RAILWAY,
- ▶ MULTIMODAL TRANSPORTATION (DIRECT MIXED RAILWAY AND WATER TRANSPORTATION)

INTERNATIONAL SHIPPING

- ▶ CARGO IMPORT FROM SOUTHEAST ASIA,
- ▶ CARGO EXPORT WORLDWIDE

CONTAINER TERMINAL SERVICES



tetra_trans



+7 800 333 46 42



TETRA TRANS

HANDLING ANY TASKS

IN CONTAINER LOGISTICS!



YEKATERINBURG

Kirov St. 40 Б, floor 5



tetratrans.ru



tetra_trans



+7 (343) 344 44 43



tetra_trans



+7 800 333 46 42



Organization of communication Novosibirsk – Kazakhstan – China

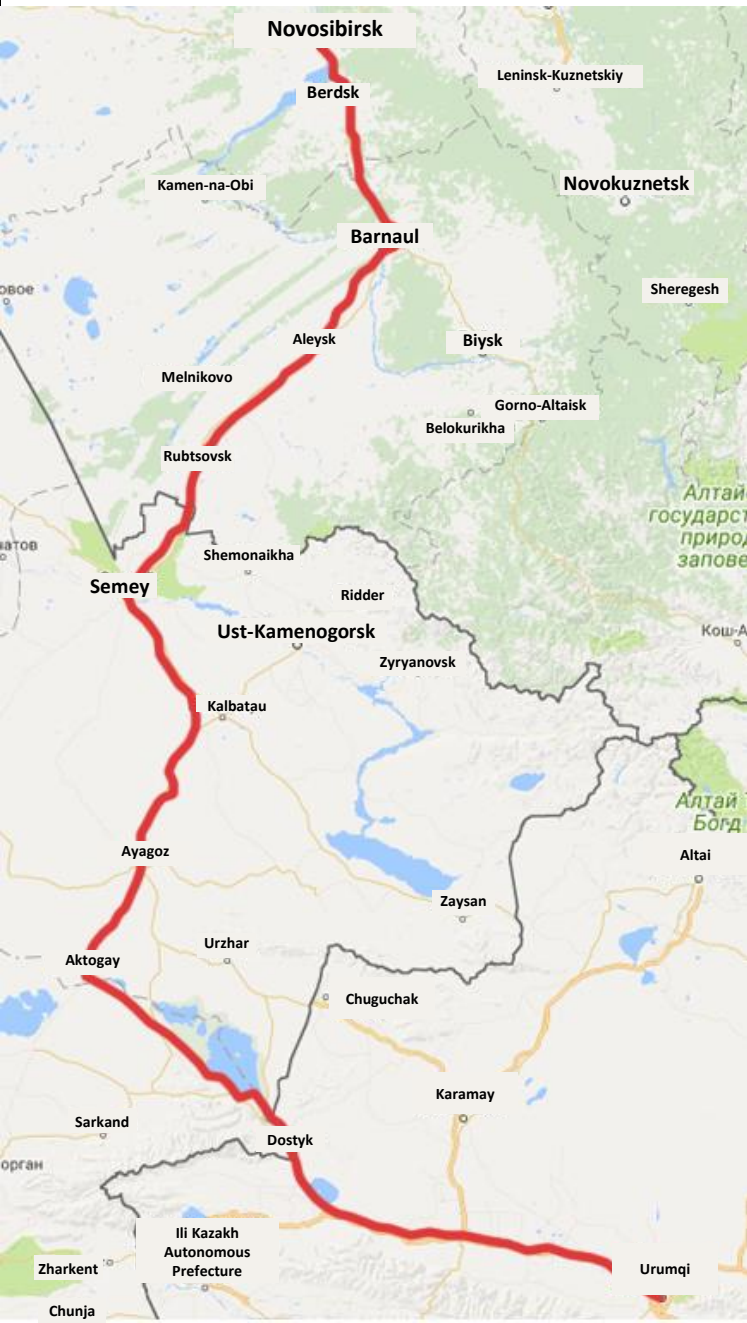

Option 1:

Formation of an accelerated container train "Novosibirsk – Dostyk – Western China"

Option 2:

Formation of a mail and baggage train "Novosibirsk - Urumqi – Novosibirsk" moving at the speed of a passenger rapid train

The Union of transport, forwarder and logistic companies of Siberia

Sergey Maksimov

The state and prospects for the development of the transport and logistics potential of the Novosibirsk region

